

Compatible with Gaia Project®

This product is not licensed, and is up for change at any time in the future.

## Assembly Guide

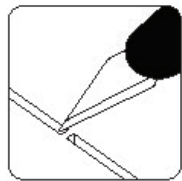

Use an exacto knife to cut the bits connecting the parts to the frame.

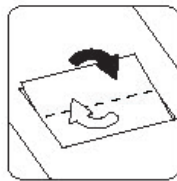

Remove the parts from the frame with a rotating motion along the axis formed by the bits you just cut.

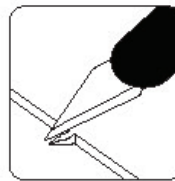

Use the exacto knife to remove any of the remaining connection bits.

Use **wood glue** for assembly. Always dry fit the parts first to make sure the components are correct ones. If you encounter any issues, please contact us at [info@laserox.net](mailto:info@laserox.net) or our Facebook page at [facebook.com/laseroxinserts](https://facebook.com/laseroxinserts).

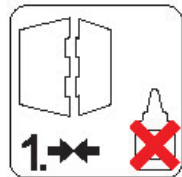

Always dry-fit the parts to together without any glue to make sure you are assembling the correct parts.

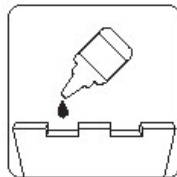

Use a drop of glue along the joints and hold it in place until the glue has sufficiently dried.

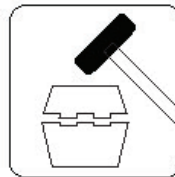

Press the parts together or use a hobby hammer with slight force for assembly.



**WARNING** Choking hazard!  
Not for children under 3 years.

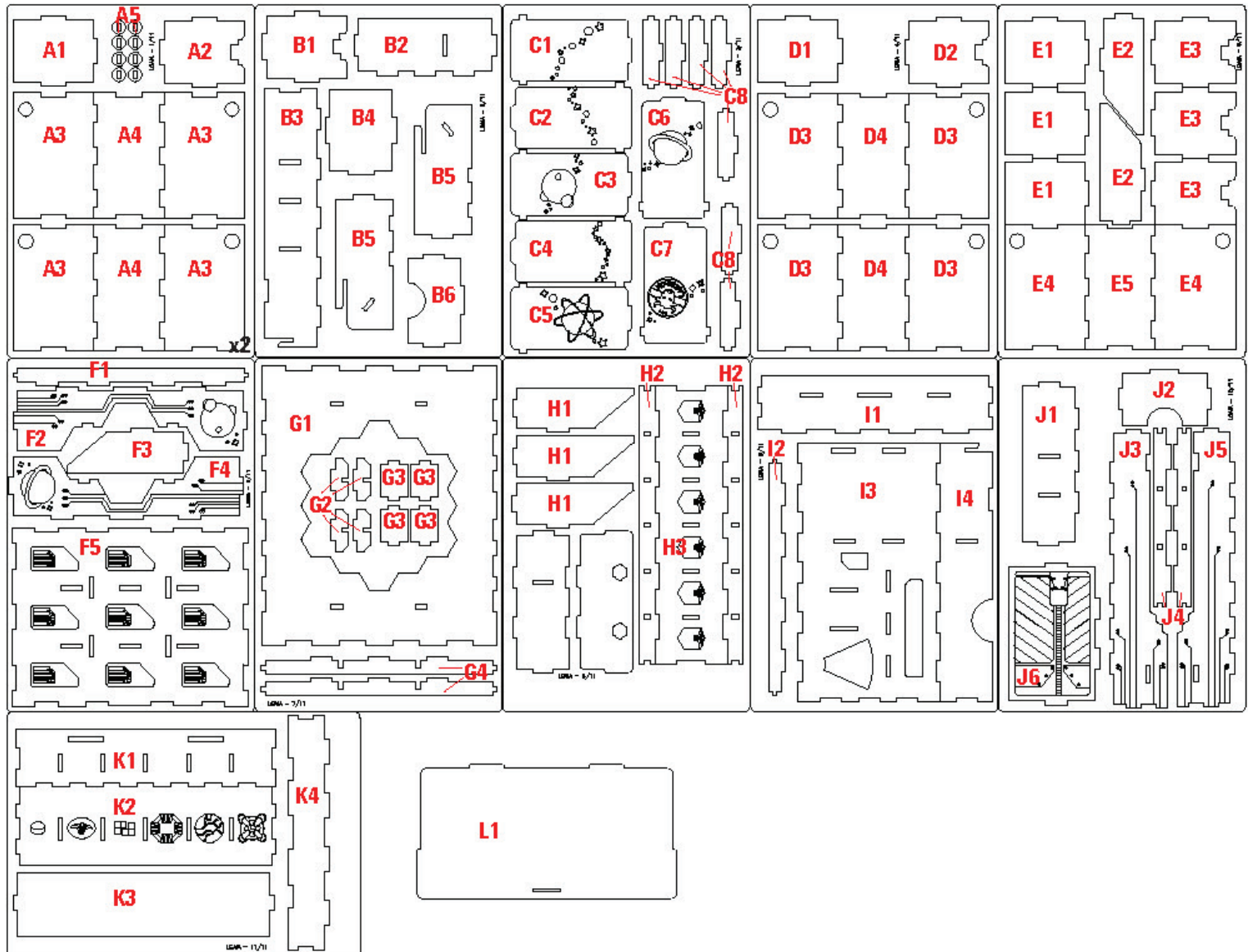

## Tiles tray

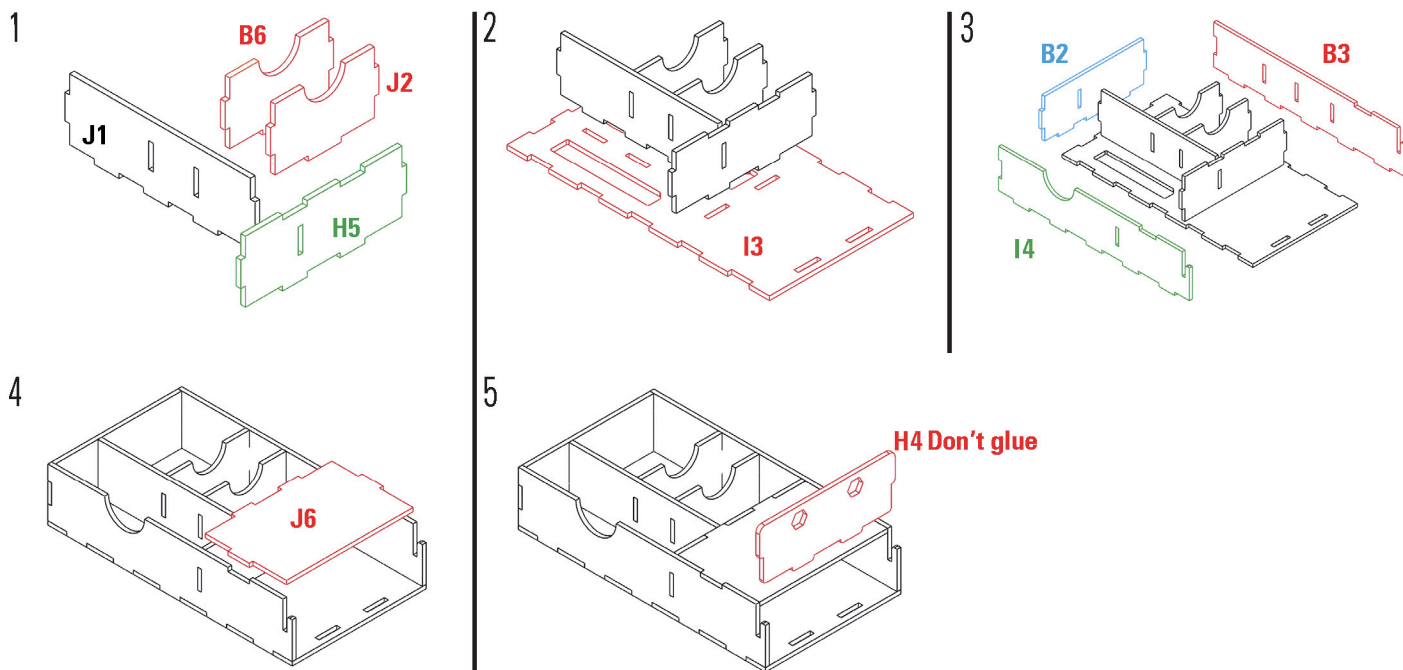

Required parts: **B2,B3,B5,H4,H5,I3,I4,J1,J2,J6**

## Fed. tokens

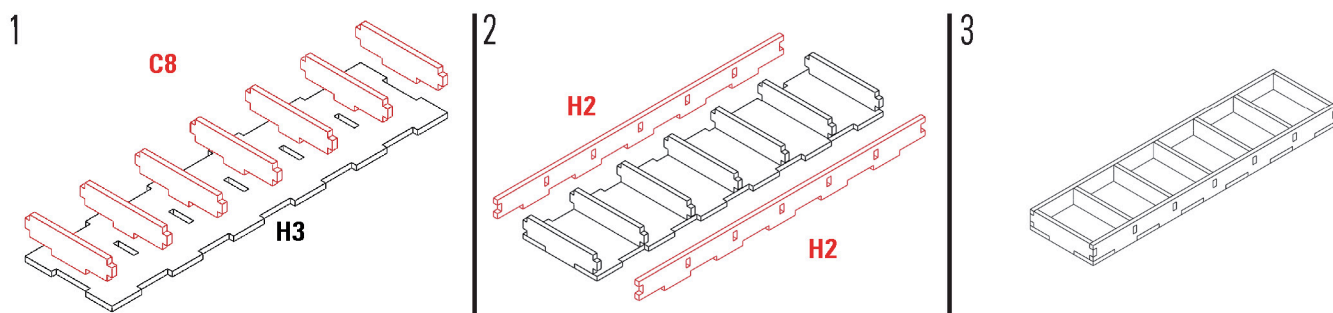

Required parts: **C8x7,H2x2,H3**

## Chits&Bits box

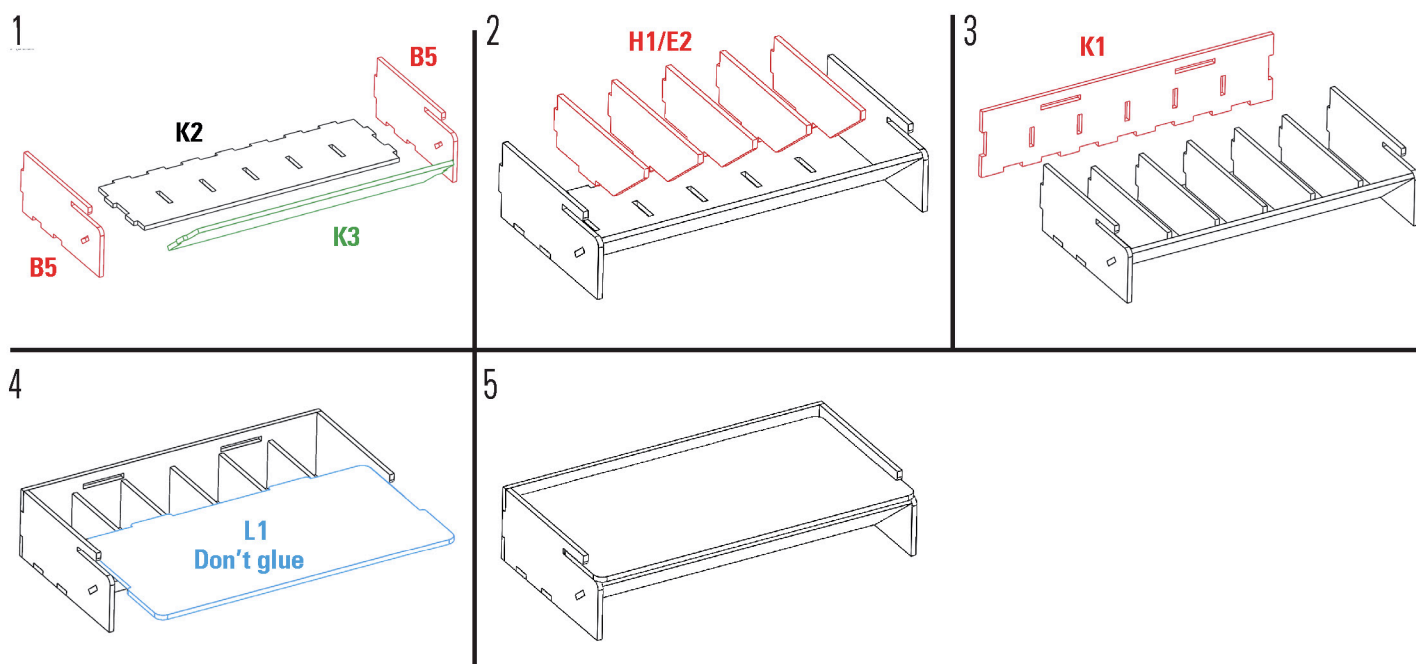

Required parts: **B5x2,E2x2,H1x3,K1,K2,K3,L1**

## Player parts

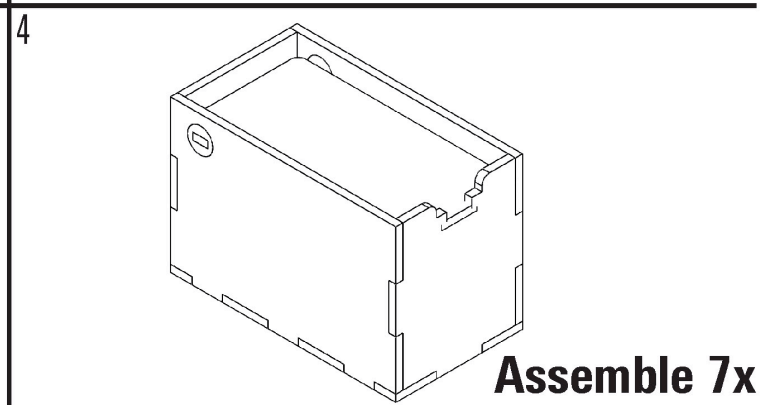
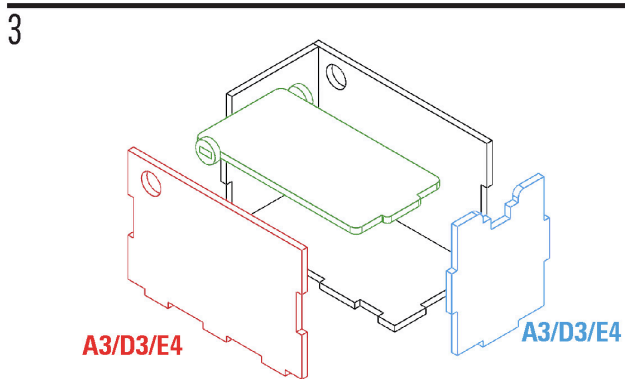
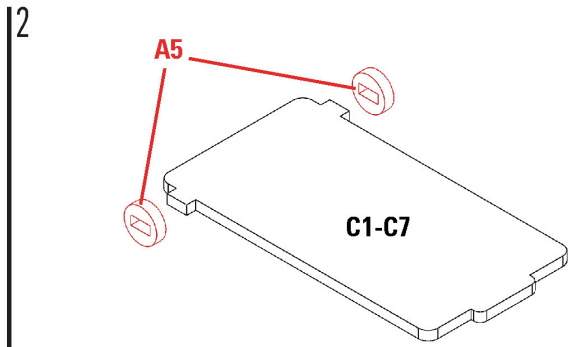
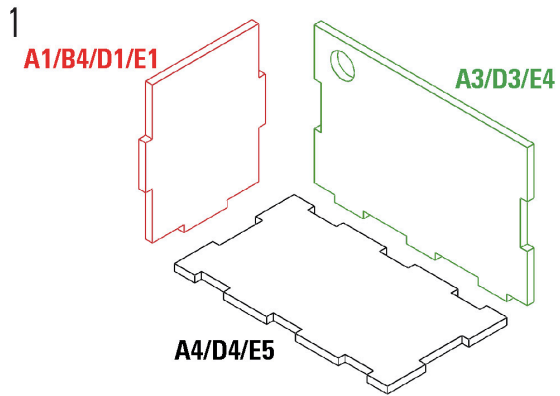

Required parts: **A1**x2,**A2**x2,**A3**x8,**A4**x4,**B1**,**B4**,**C1**,**C2**,**C3**,**C4**,**C5**,**C6**,**C7**,**D1**,**D2**,**D3**x4,**D4**x2,**E1**x3,**E3**x3,**E4**x2,**E5**

## Advanced tech tiles tray

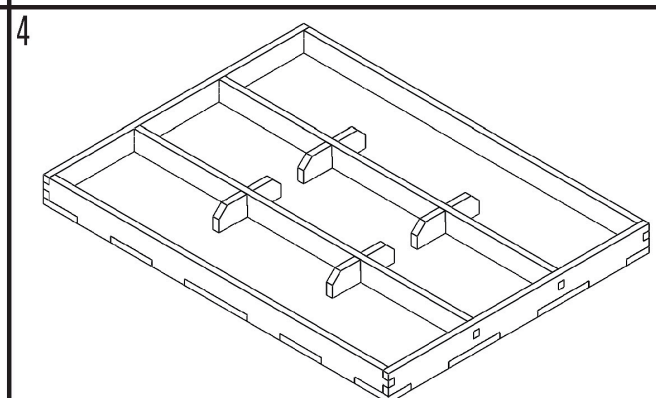
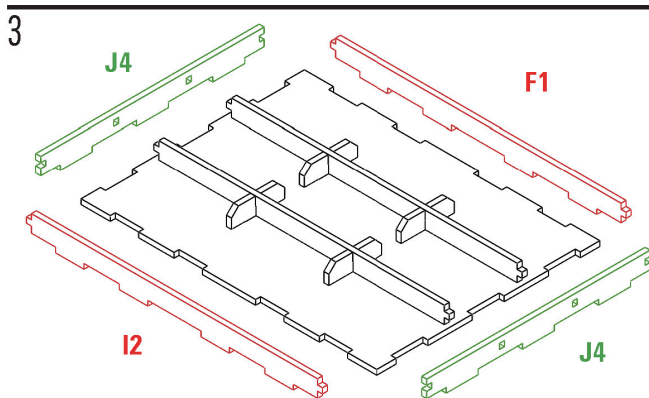
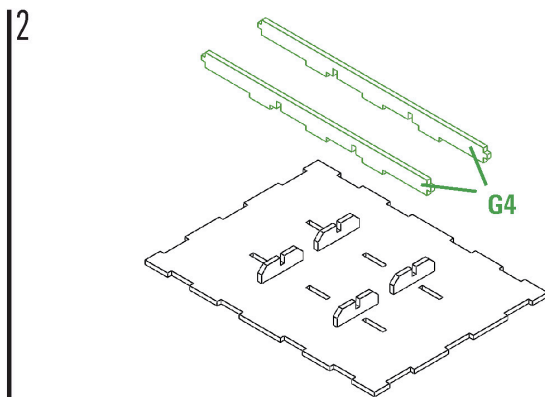
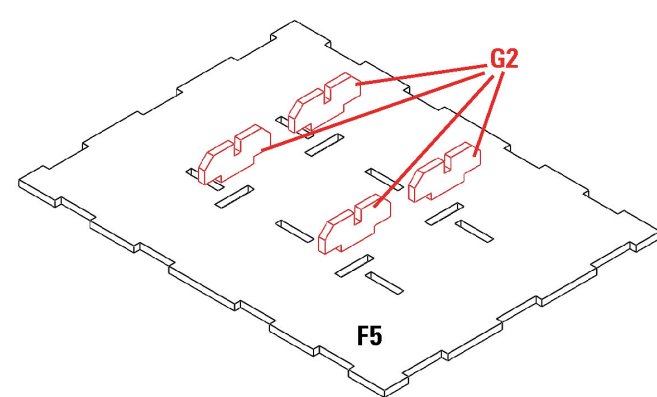

Required parts: **F1**,**F5**,**G2**x4,**G2**x2,**I2**,**J4**x2

## Map tiles

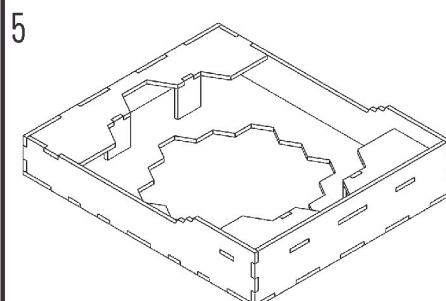
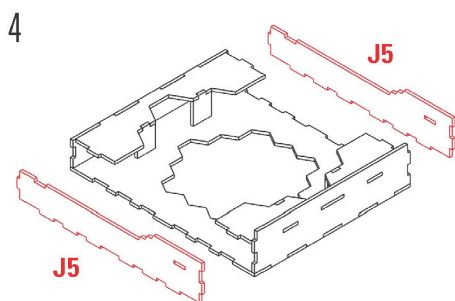
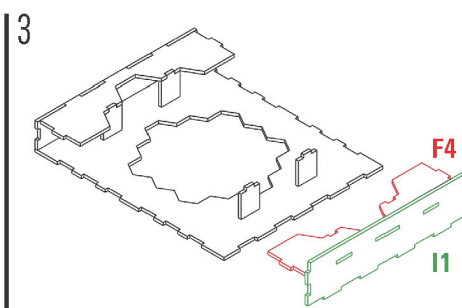
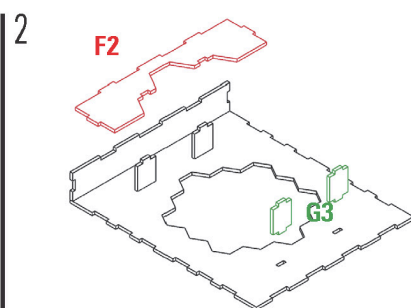
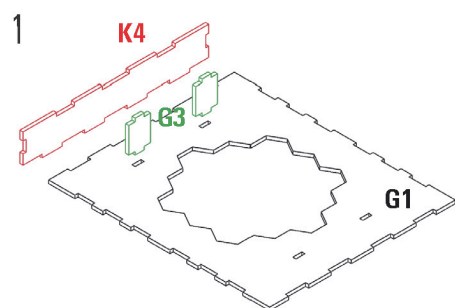

Required parts: **F2,F4,G1,G3x4,I1,J3,J5**

## Fed. tokens

