

Dwarven Mine

LCAV

Compatible with Caverna
& Caverna: The Forgotten Folk®

This box organizer is compatible with Caverna®
This product is officially licensed by Lookout Games and is up
for change at any time in the future.



LASEROX

Assembly Guide

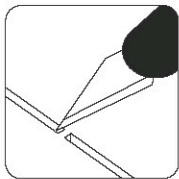

Use an exacto
knife to cut the
bits connecting
the parts to the
frame.

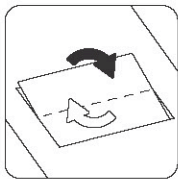

Remove the parts
from the frame with
a rotating motion
along the axis
formed by the bits
you just cut.

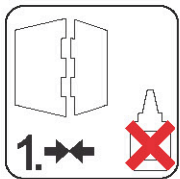

Always dry-fit the
parts to together
without any glue
to make sure you
are assembling the
correct parts.

Use **wood glue** for assembly.
Always dry fit the parts first to
make sure the components are
correct ones. If you encounter any
issues, please contact us at
info@laserox.net or our Facebook
page at [facebook.com/laseroxinserts](https://www.facebook.com/laseroxinserts).

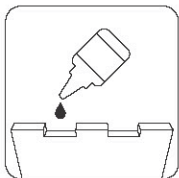

Use a drop of
glue along the
joints and hold
it in place until
the glue has
sufficiently dried.

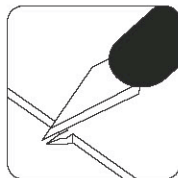

Use the exacto
knife to remove
any of the
remaining
connection bits.

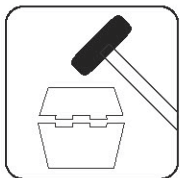

Press the parts
together or use a
hobby hammer
with slight force
for assembly.



WARNING Choking hazard!
Not for children under 3 years.

Part numbers

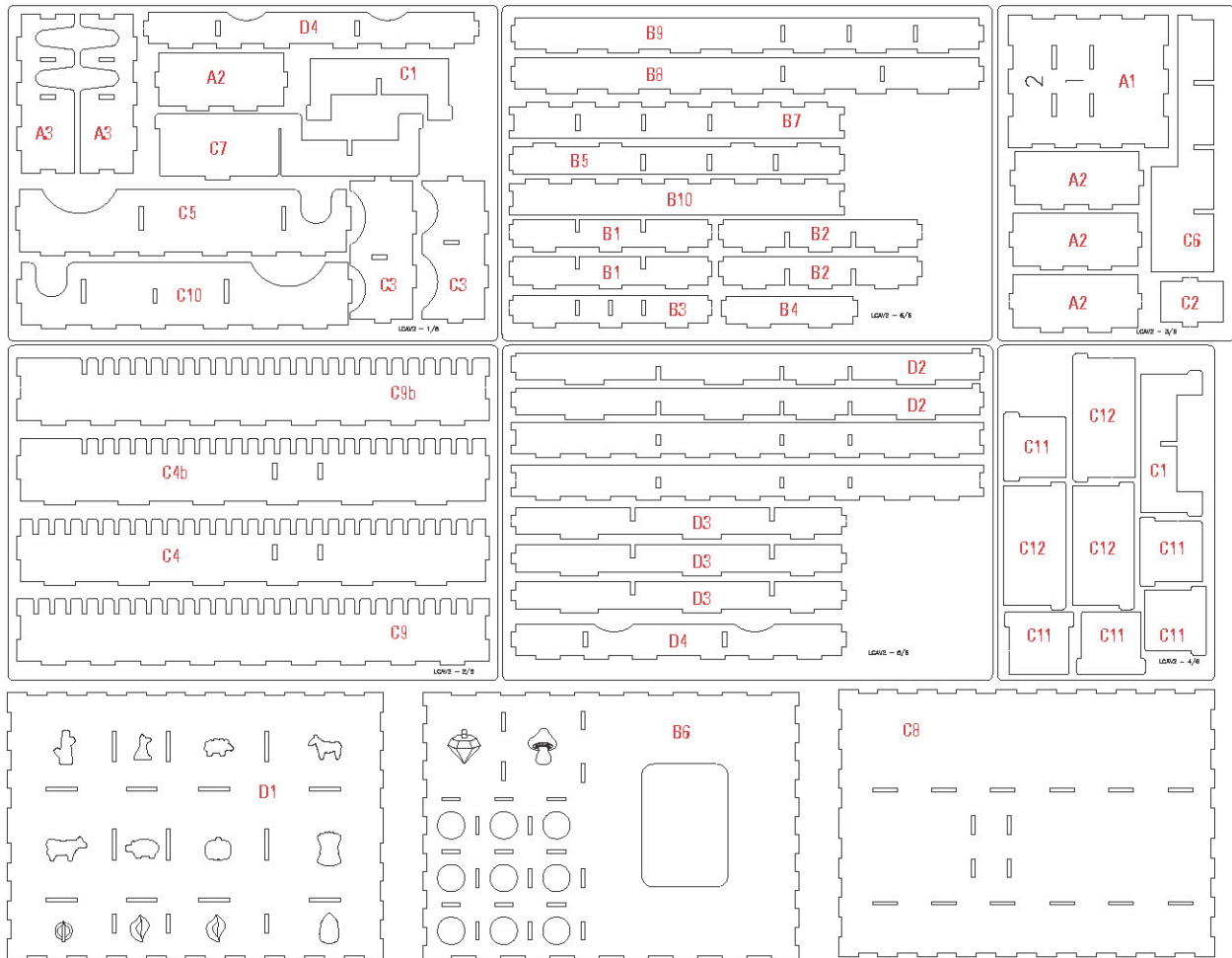

Part 1. Coins

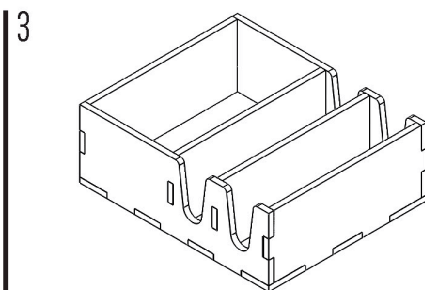
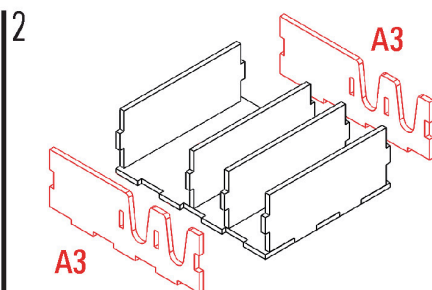
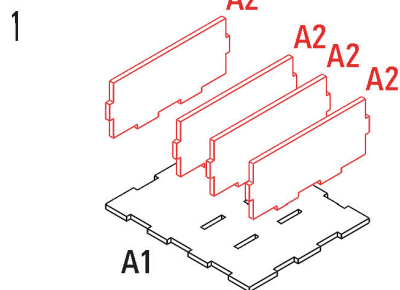

Required parts: **A1**, **A2**x4, **A3**x2

Part 2. Expansion tray

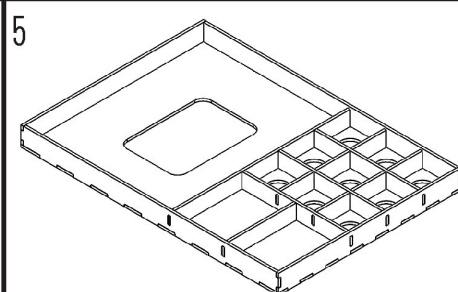
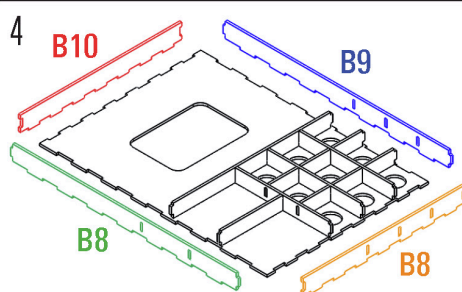
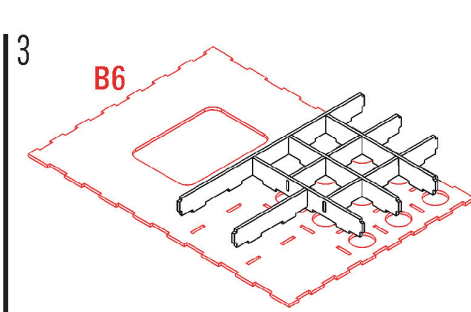
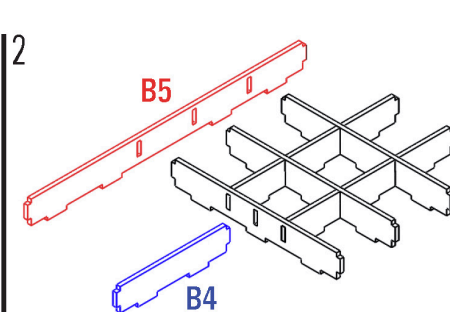
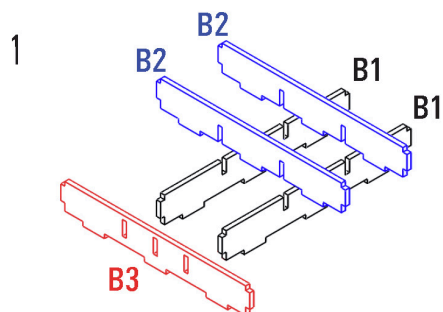

Required parts: **B1**x2, **B2**x2, **B3**, **B4**, **B5**, **B6**, **B7**, **B8**, **B9**, **B10**

Part 3. Cardboard tray

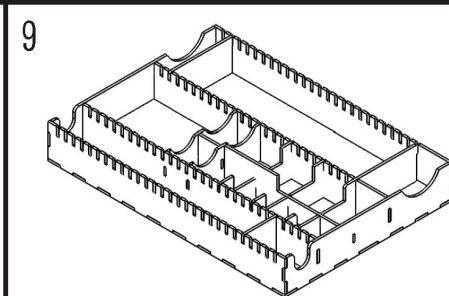
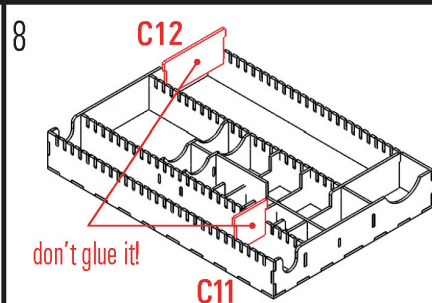
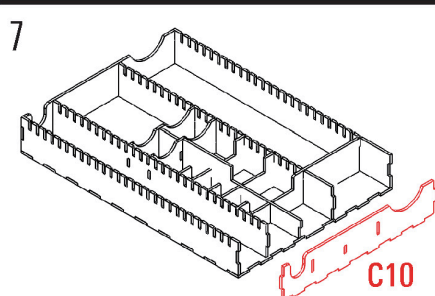
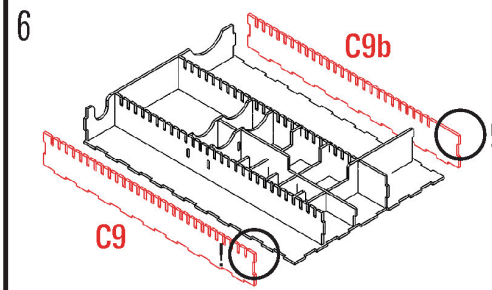
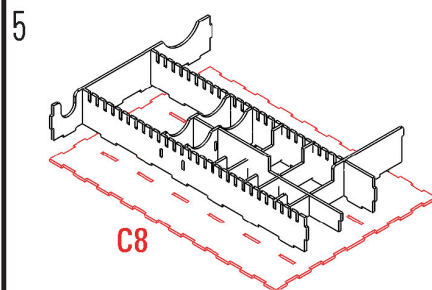
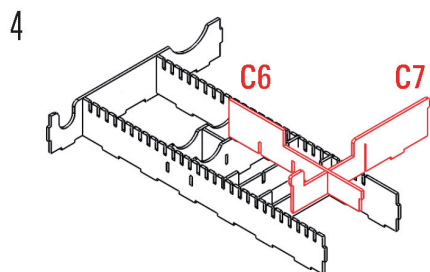
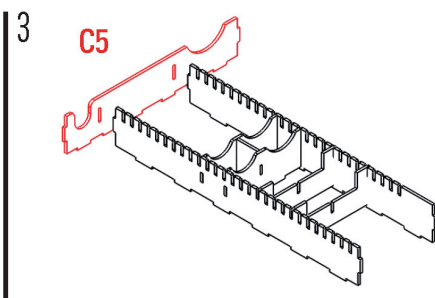
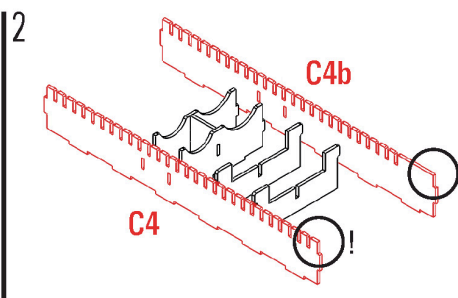
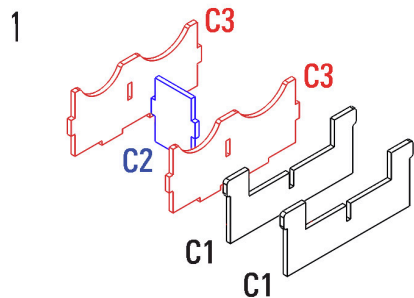

Required parts: **C1**x2, **C2**, **C3**x2, **C4**, **C4b**, **C5**, **C6**, **C7**, **C8**, **C9**, **C9b**, **C10**, **C11**x5 (optional), **C12**x3 (optional)

Assembly

Part 4. Resource tray

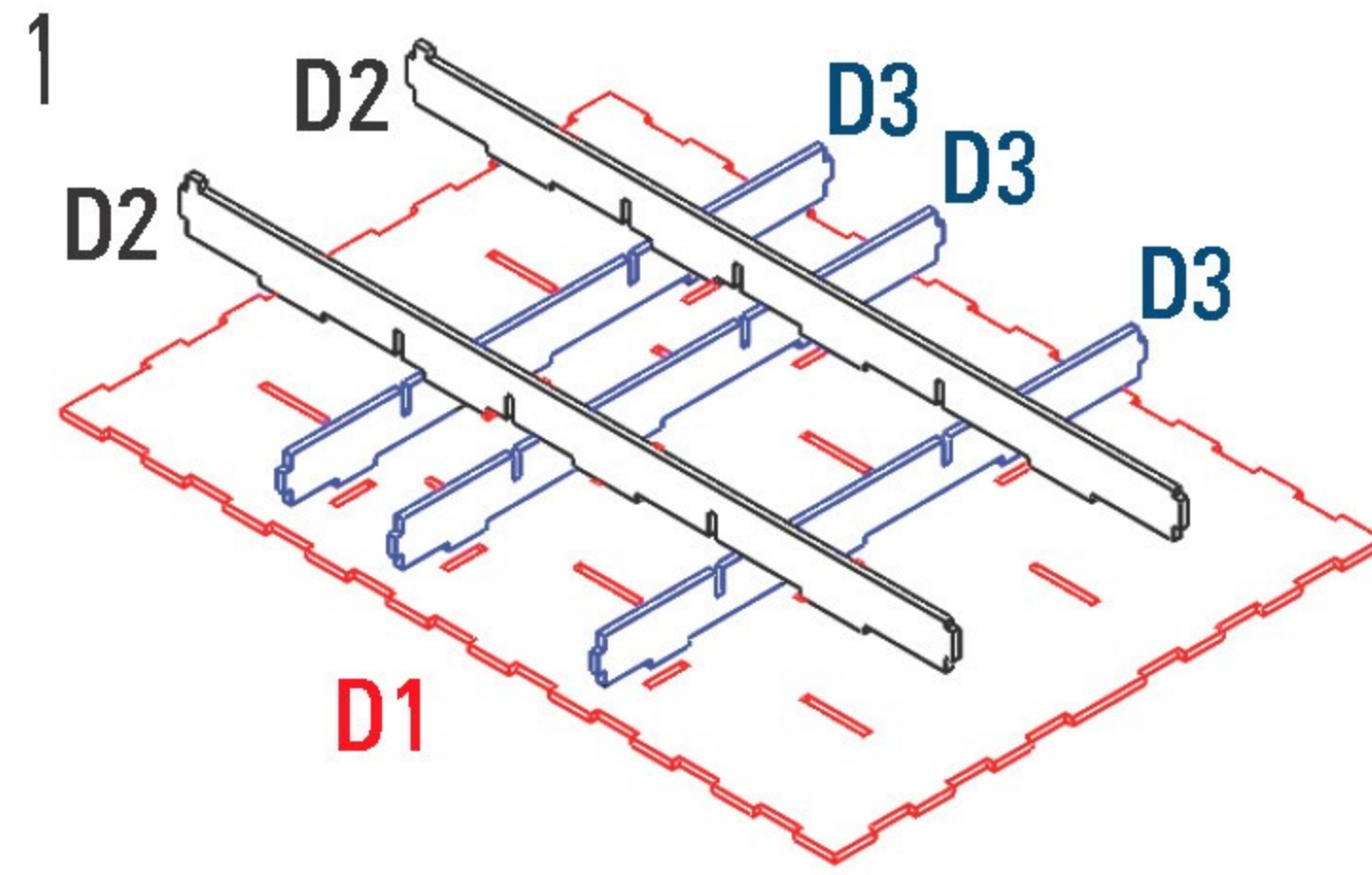

Required parts: **T1**, **B2x2**, **B4x2**, **PX3**

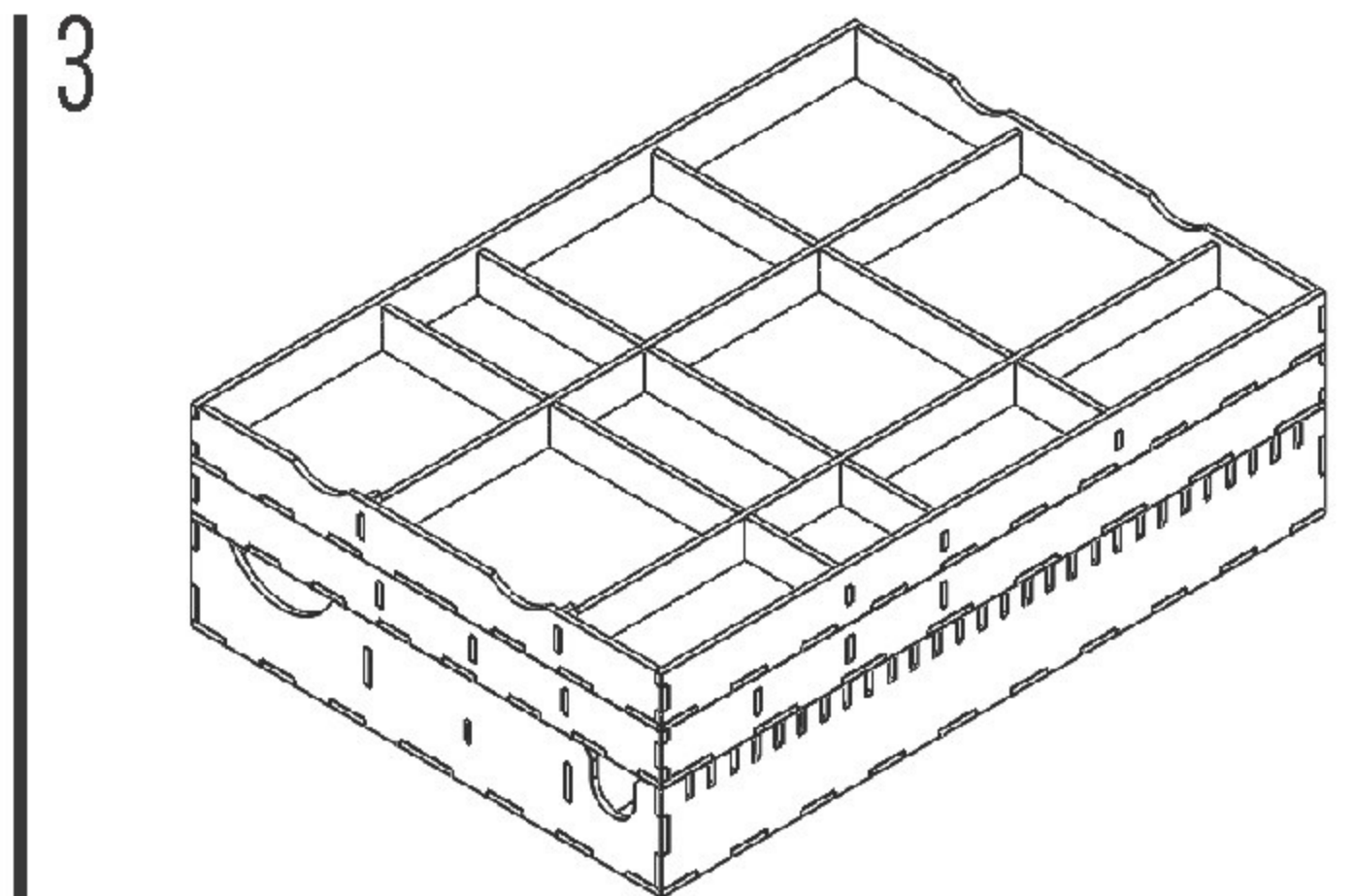
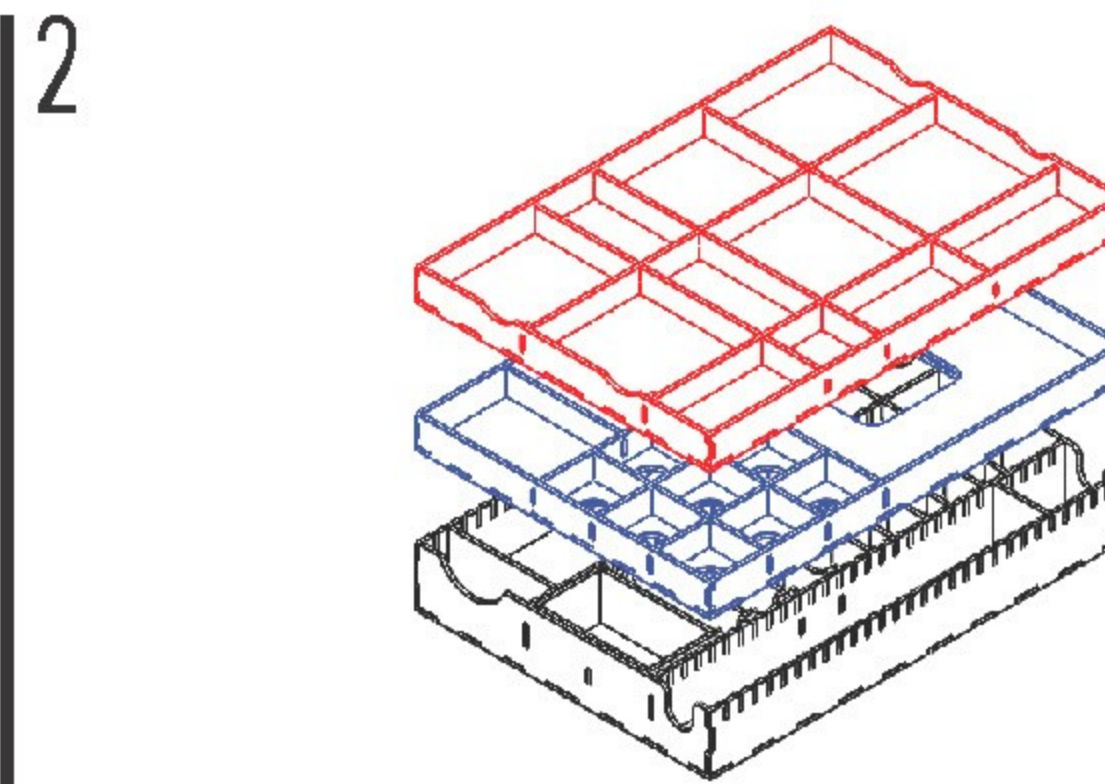
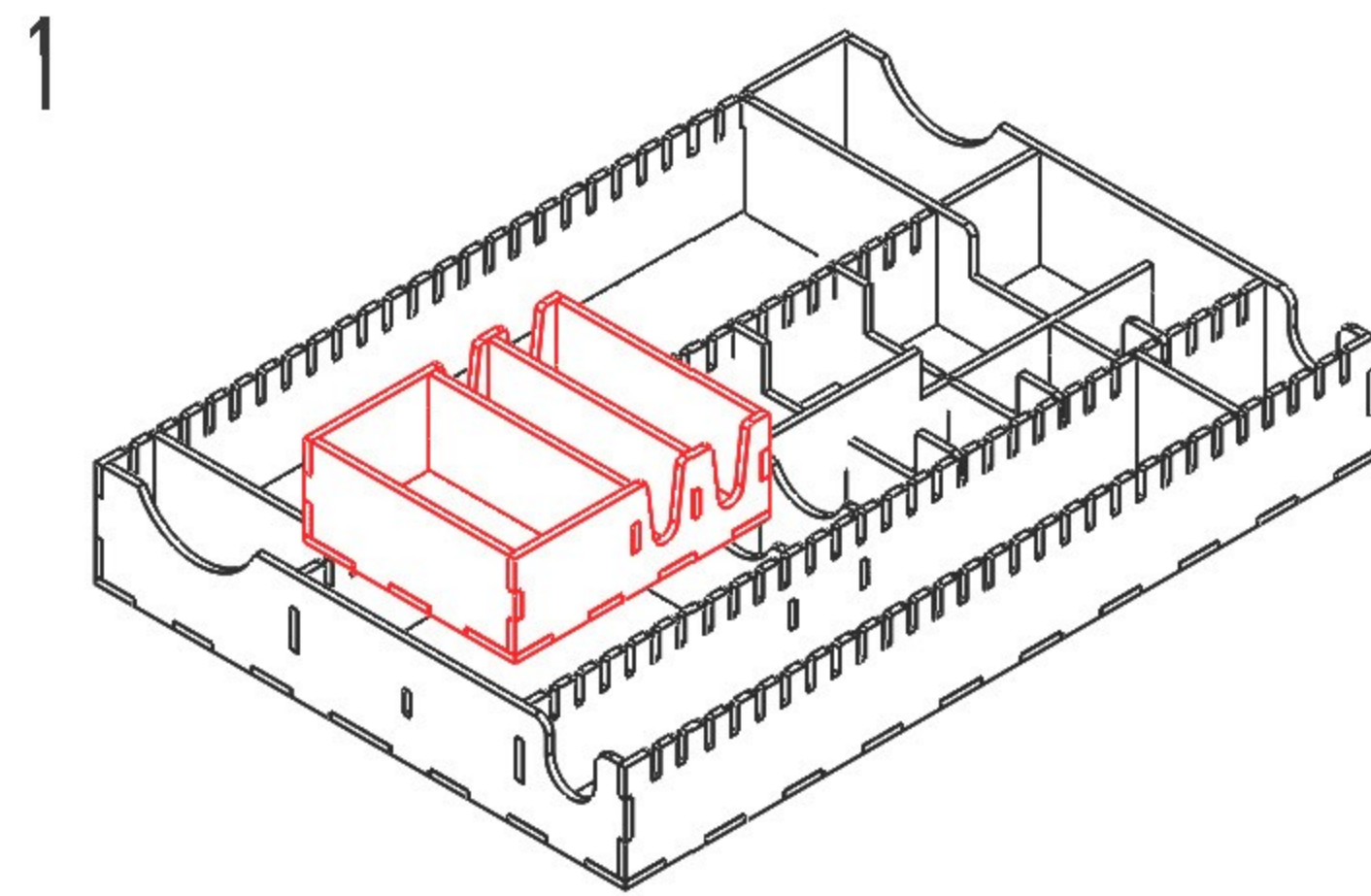
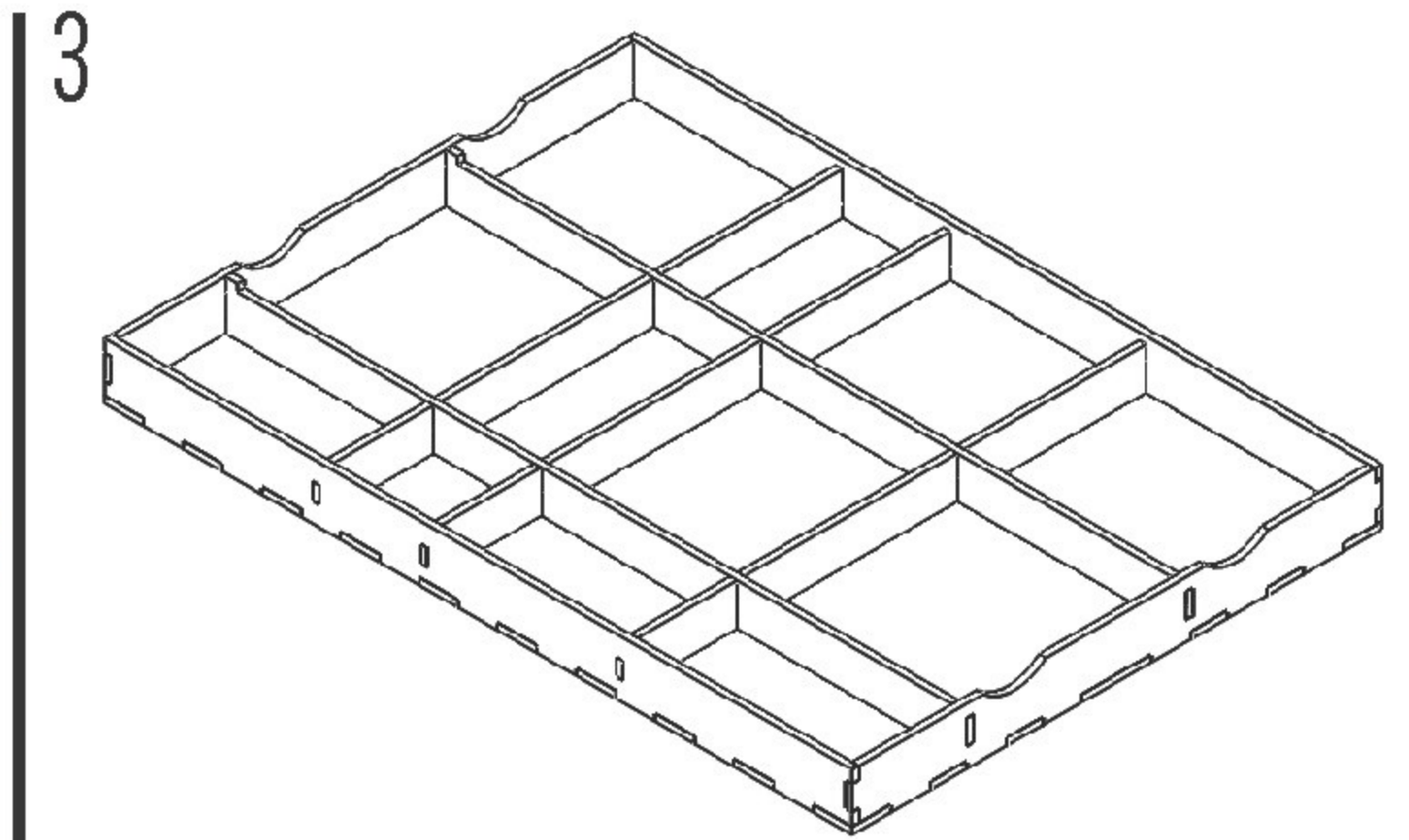
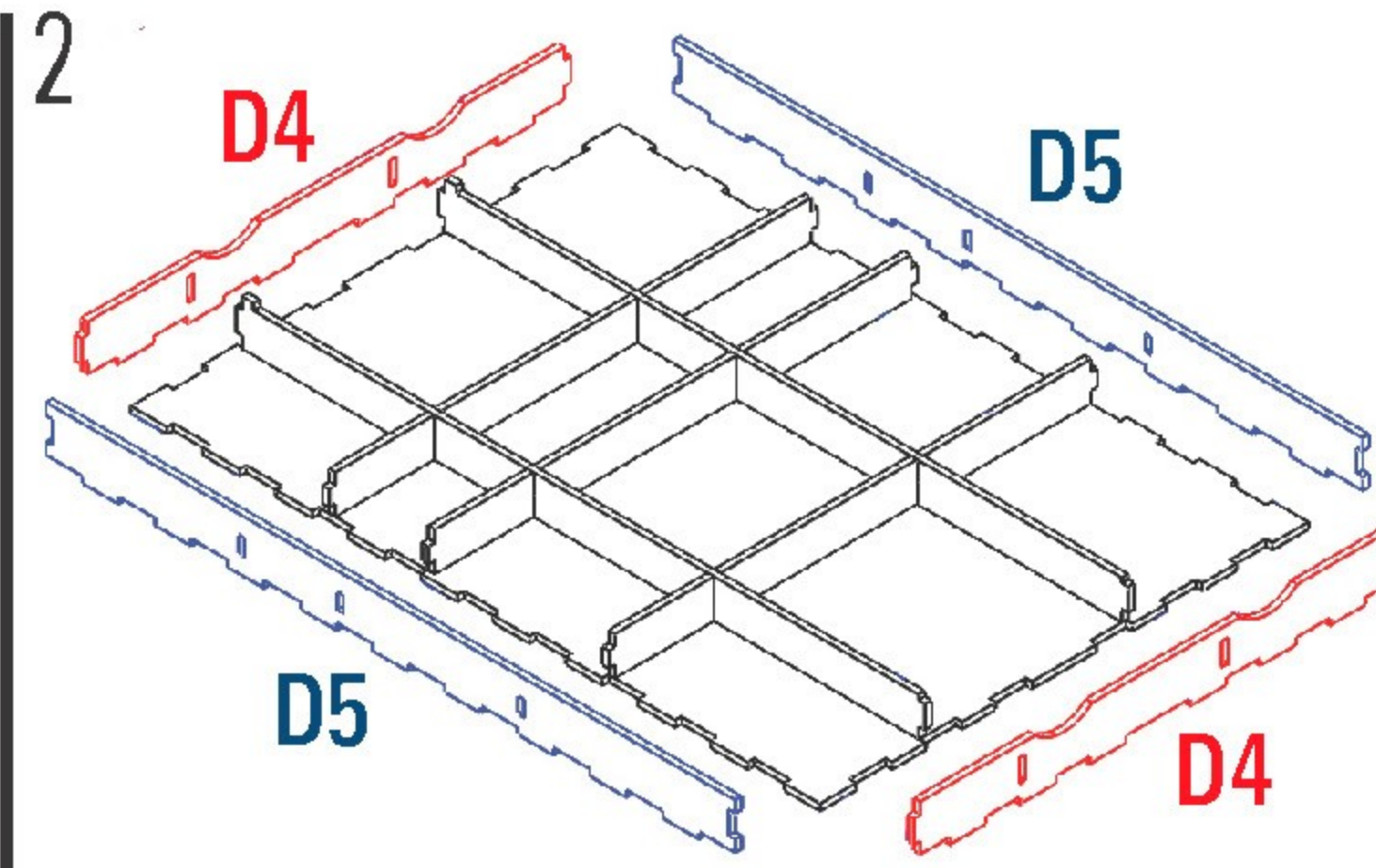

LCAV II.



We would like to extend our offer to you:

