

Quacks Organizer

L000

Compatible with Quacks of Quedlinburg

and the following expansions:

The Alchemists

The Herb Witches

This product is not licensed, and is up for change at any time in the future.



Assembly Guide



Watch our beginners guide videos on youtube. Just scan the QR code and get started!

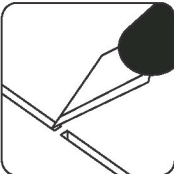

Use an exacto knife to cut the bits connecting the parts to the frame.

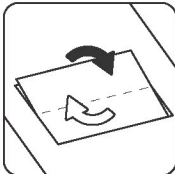

Remove the parts from the frame with a rotating motion along the axis formed by the bits you just cut.

Use **wood glue** for assembly. Always dry fit the parts first to make sure the components are correct ones. If you encounter any issues, please contact us at info@laserox.net or our Facebook page at facebook.com/laseroxinserts.

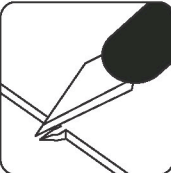

Use the exacto knife to remove any of the remaining connection bits.

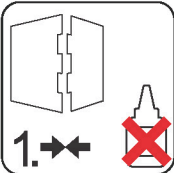

Always dry-fit the parts to together without any glue to make sure you are assembling the correct parts.

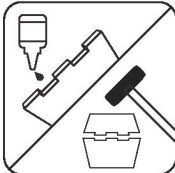

Use a drop of glue along the joints and press the parts together or use a hobby hammer with slight force for assembly.



5 999567 862181



WARNING Choking hazard!
Not for children under 3 years.

Part numbers

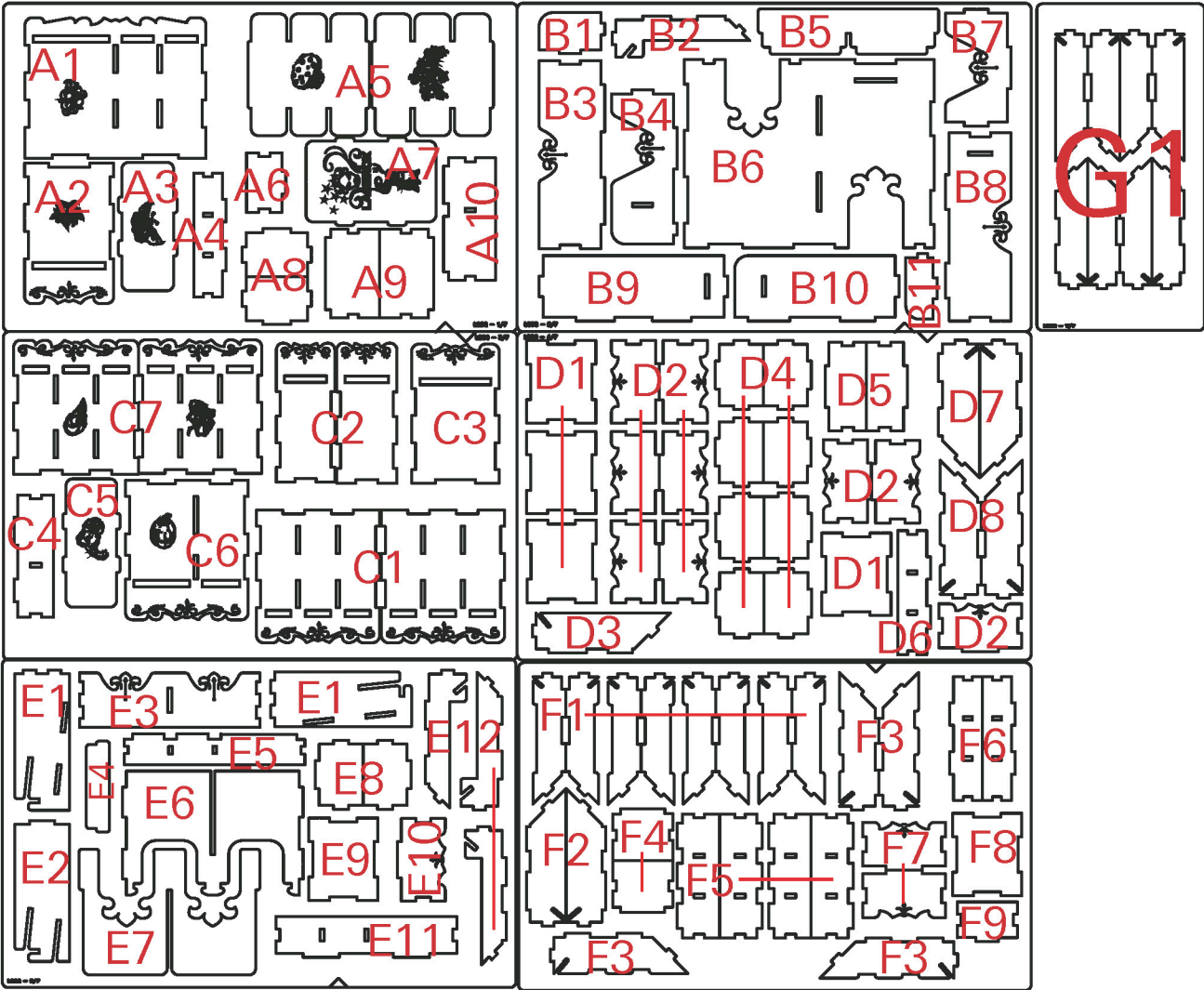

Book holder

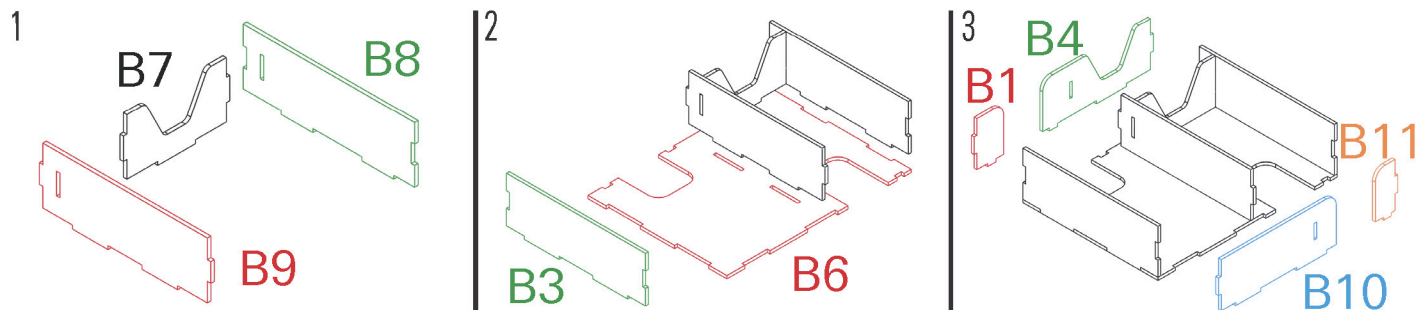

Required parts: **B1,B3,B4,B6,B7,B8,B9,B10,B11**

Card tray

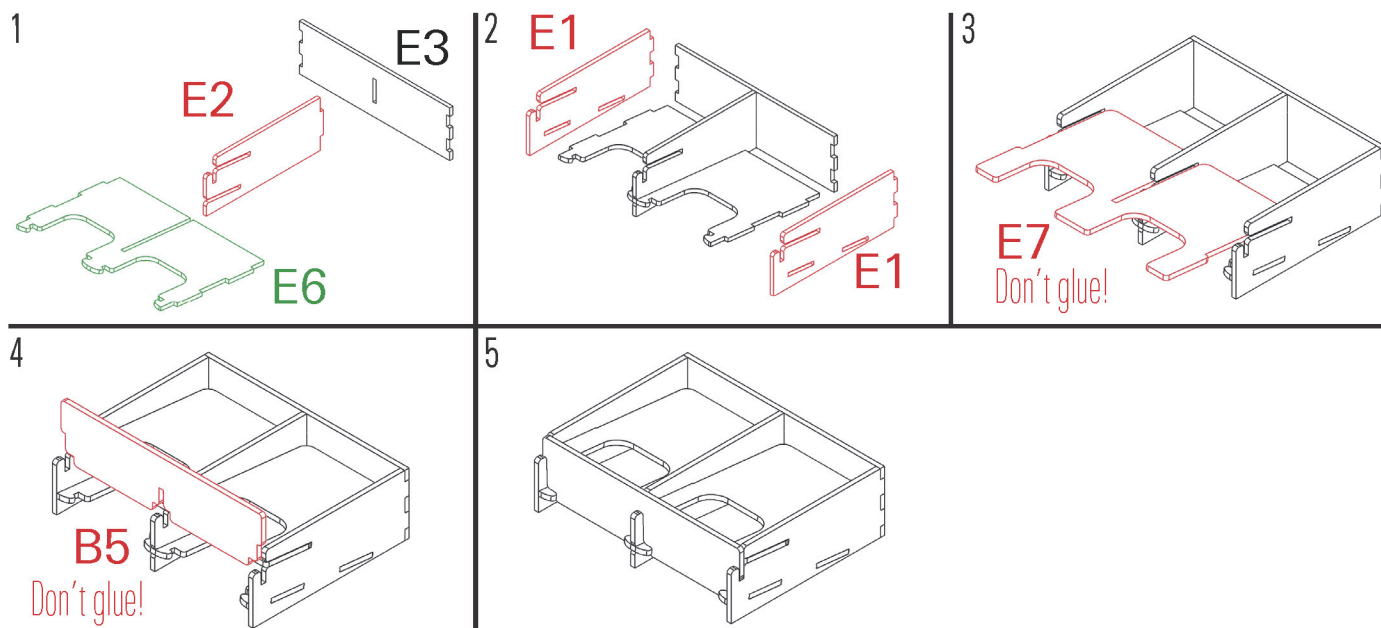

Required parts: **B5,E1x2,E2,E3,E6,E7**

Cherry bomb

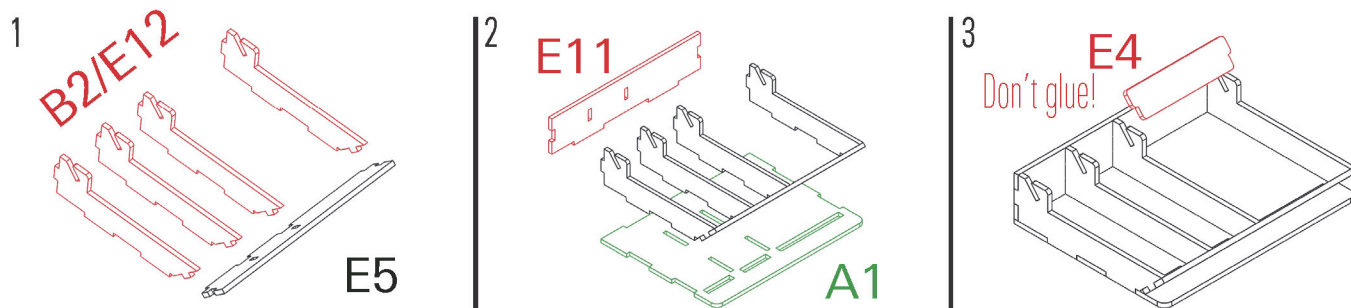

Required parts: **A1,B2,E4,E5,E11,E12x3**

Token tray

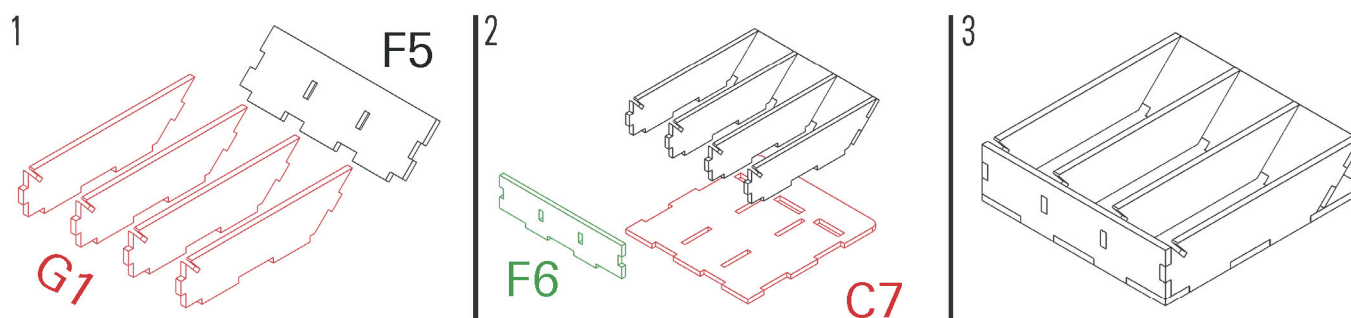

Required parts: **C7, F5, F6, G1x4**

Assemble 2x

Top token tray

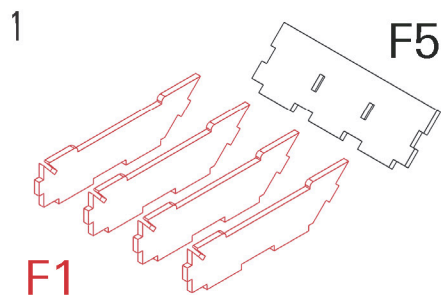

Required parts: **A4,A5,C1,D6,F1x4,F5**

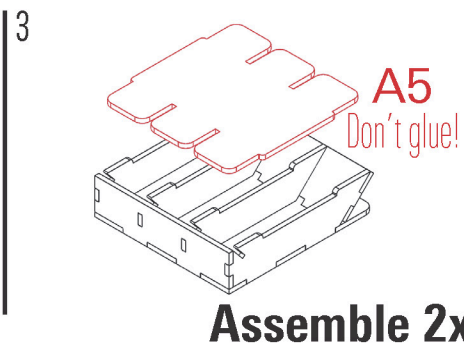
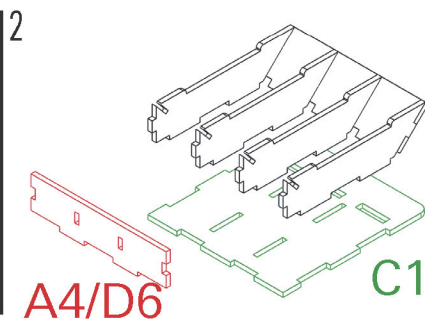

Pumpkins

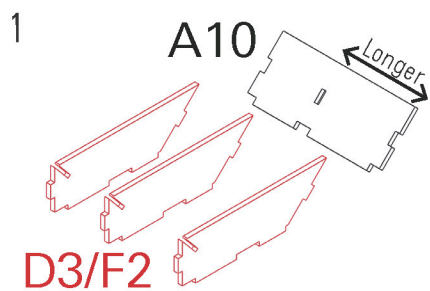

Required parts: **A10,C4,C6,D3,F2x2**

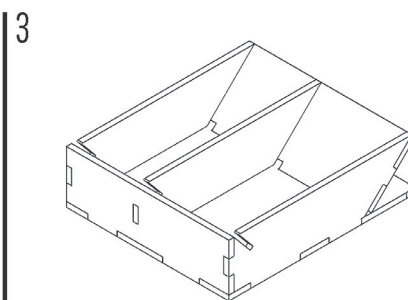
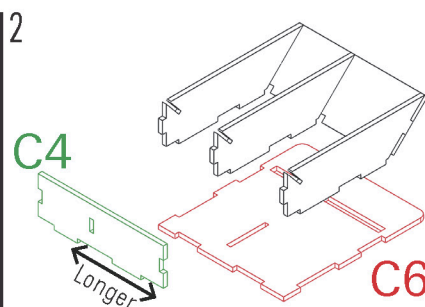

Small resources

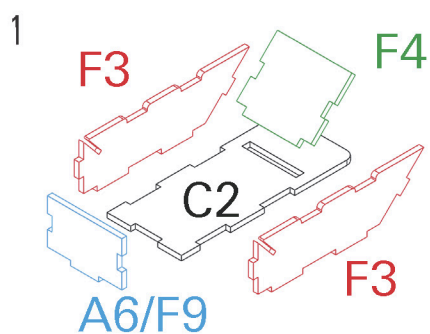

Required parts: **A3,A6,C2x2,C5,F3x4,F4x2,F9**

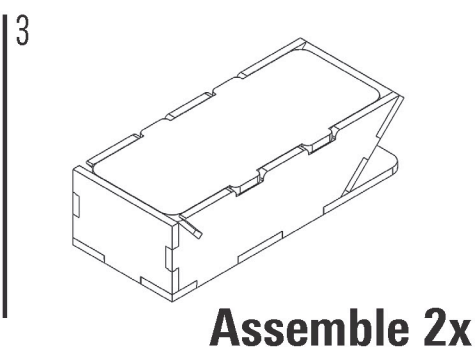
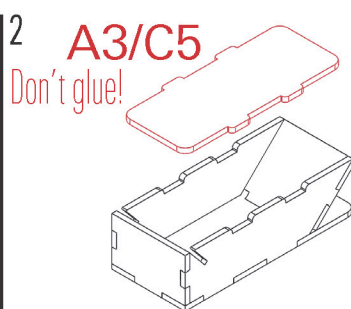

Locoweed

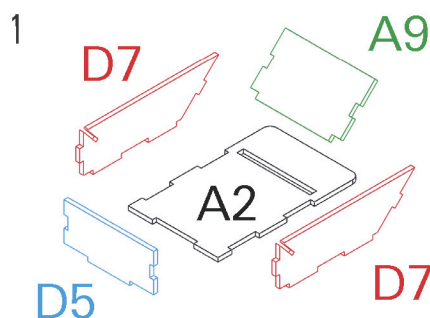

Required parts: **A2,A9,D5,D7x2**

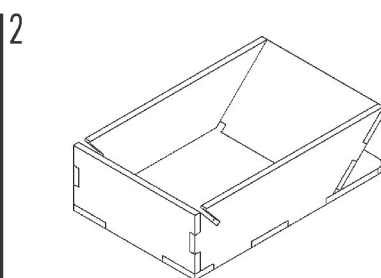

Crystals

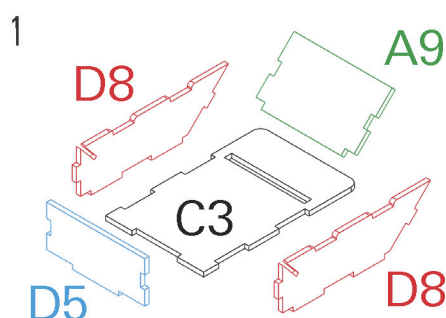

Required parts: **A7,A9,C3,D5,D8x2**

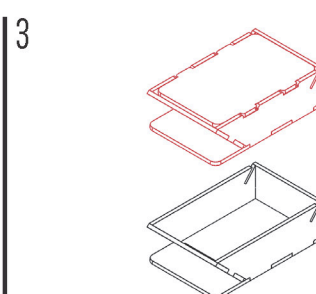
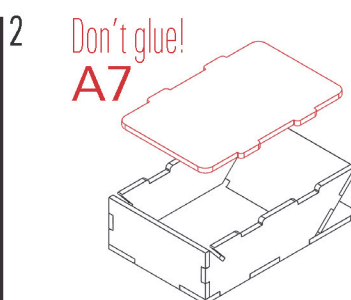

Player holder

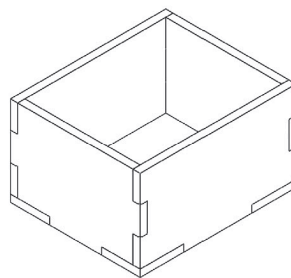
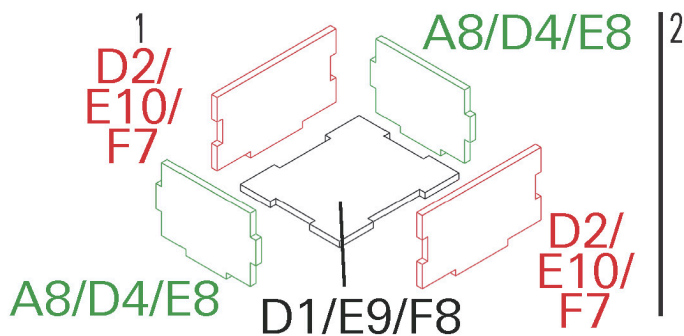

Assemble 6x

Required parts: **A8x2, D1x4, D2x9, D4x8, E8x2, E9, E10, F8, F7**

Assembly

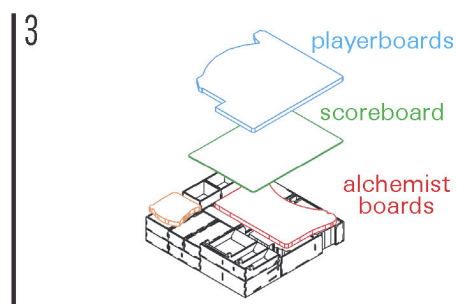
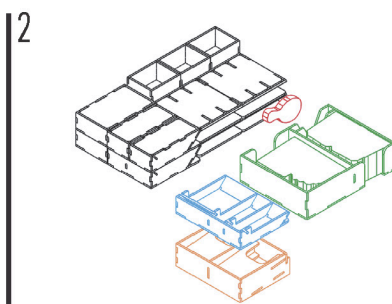
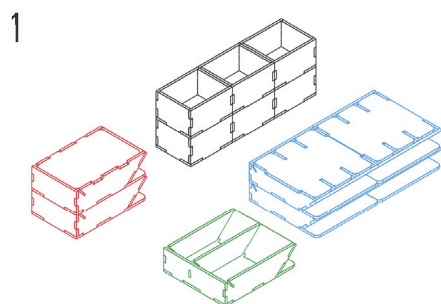

Lost Ruins of Arnak



Viscounts of the West Kingdom



Praga Caput Regni

